

Pennyweight Gully



TOWNHOUSE 09

233 JOSEPH ST CANADIAN



Ground Floor Residence Area:
73.65m² (7.93 sq)

First Floor Residence Area
(including stairs/void):
79.05m² (8.51 sq)

Total Residence Area:
152.70m² (16.44 sq)

Balcony Area:
13.33m²

Garage Floor Area:
46.80m² (5.03 sq)

Total Building Area
(including balcony and garage):
212.83m² (22.91 sq)

SALES ENQUIRIES:

Ben Halsall
0400 223 887
bhalsall@buxton.com.au
632 Sturt Street, Ballarat
03 5331 4544

GROUND FLOOR

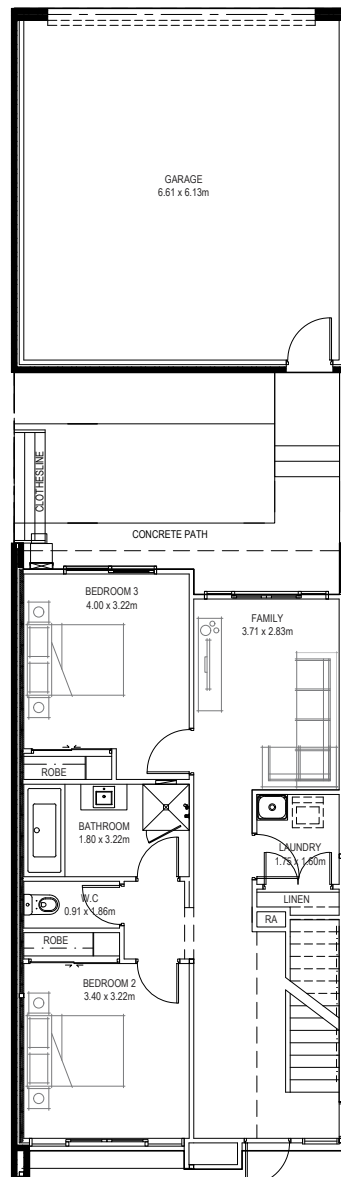

LEVEL 1

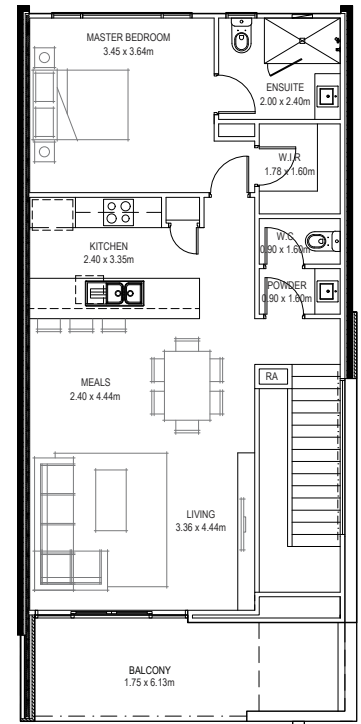

Pennyweight Gully

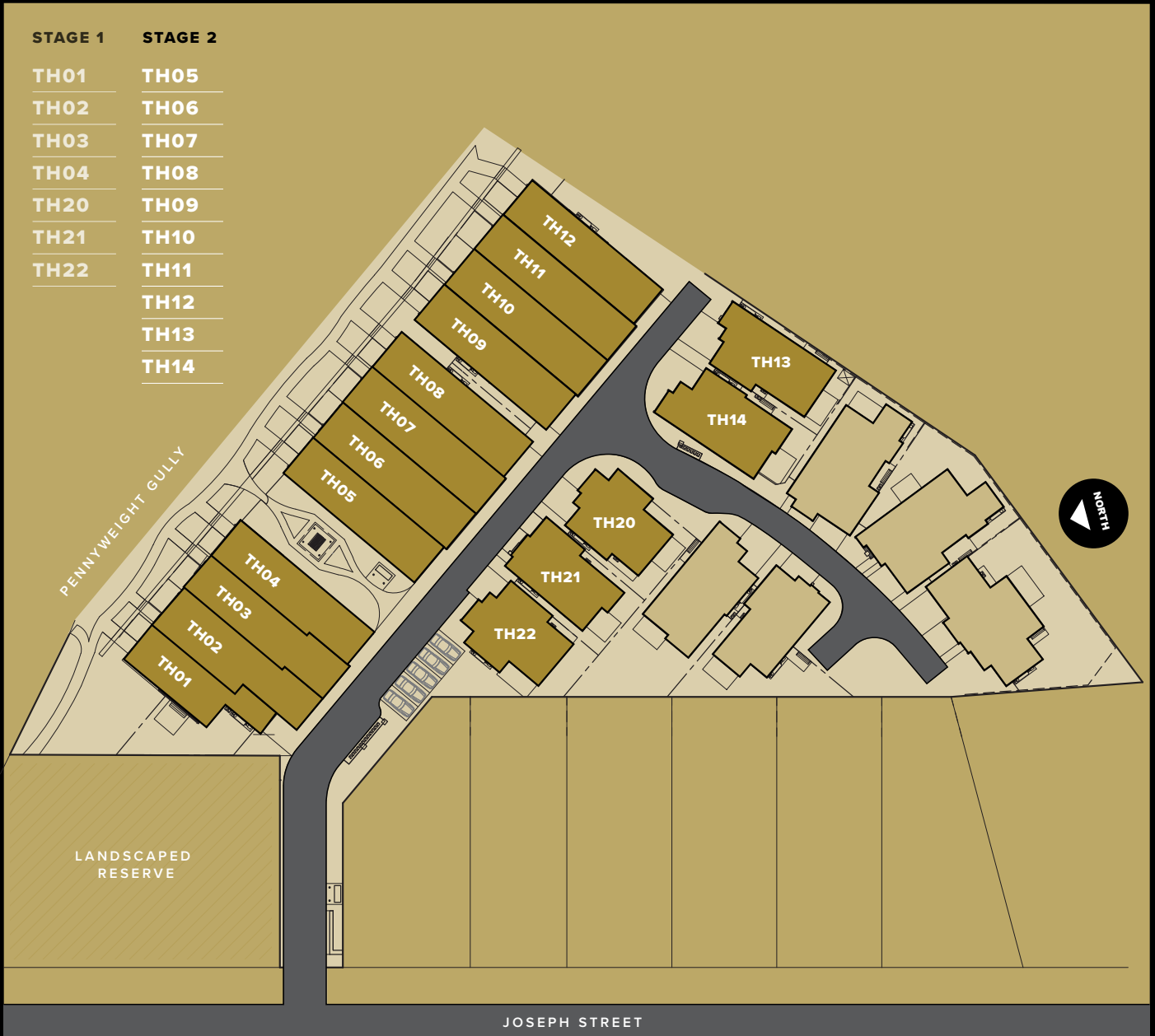

**STAGE 2 NOW SELLING.
SECURE YOURS NOW.**

SALES ENQUIRIES:
Ben Halsall
0400 223 887
bhalsall@buxton.com.au
632 Sturt Street, Ballarat
03 5331 4544

buxton